

Main Floor

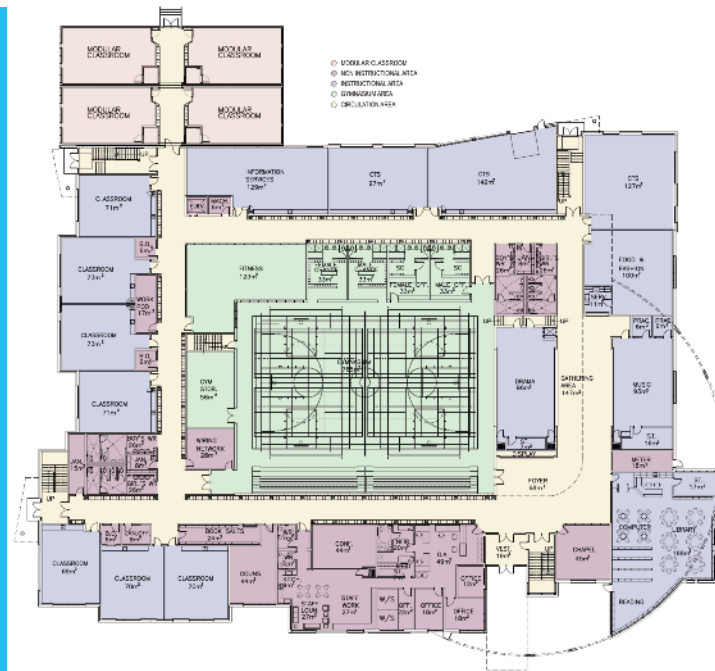

Second Floor

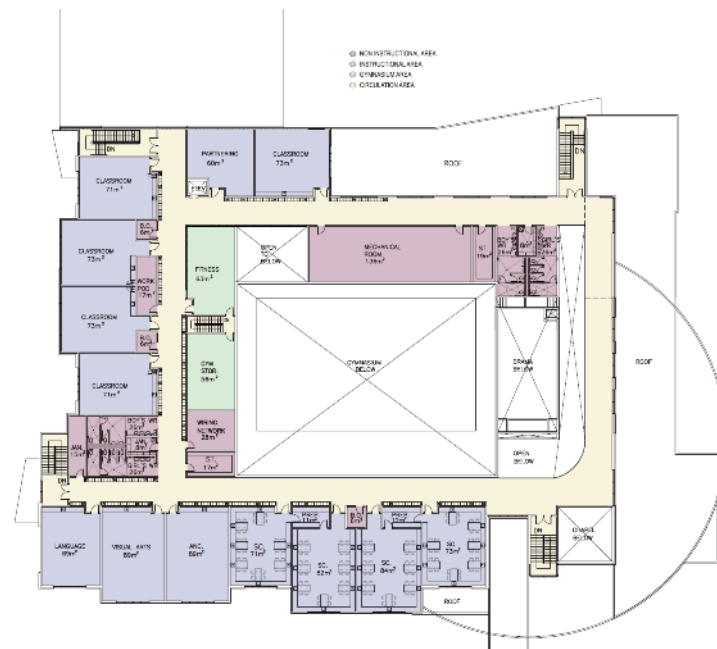

Site Plan

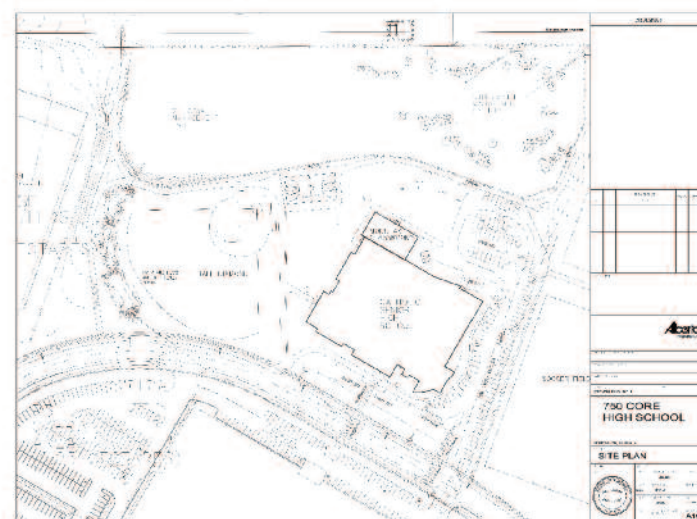

Mother Margaret Mary Catholic High School

Grades 9-12 Terwillegar
Southwest Edmonton | 2010 Leger Road N.W.



EDMONTON CATHOLIC SCHOOLS

Born Laura Hickey in 1890, Mother Margaret Mary became a member of the Faithful Companions of Jesus (FCJ) congregation in 1910. The FCJ sisters were the first community of religious women who taught in Edmonton Catholic Schools, beginning in 1888. She studied in England and Belgium, but most importantly, she was the first female religious to attend the University of Alberta and the first to graduate with a Masters degree in 1916.

Mother Margaret Mary taught in Edmonton Catholic Schools for 50 years. She began her teaching career as the principal of St. Mary Boys and Girls School in 1911. When St. Mary became a Girls' High School in 1923, Mother Margaret Mary remained as principal, thereby becoming the first woman high school administrator in the Edmonton Catholic School District. She remained in this position until 1954 when the school was amalgamated with St. Joseph High School, and she continued teaching from 1954 until her retirement in 1961.

Mother Margaret Mary was best known for her ability as a mathematics teacher, but her strong academic background and personal qualities of versatility and flexibility allowed her to teach almost any subject. Representing not just herself but all the teaching members of the FCJ congregation, Mother Margaret Mary serves as an inspiration for young women and men alike to take on long-term leadership and service roles.

Mother Margaret Mary died in 1989, 11 days before her 100th birthday.



Fact Sheet

Grades 9 - 12
 Location: 2010 Leger Road N.W. (Terwillegar, S.W. Edmonton)
 Capacity: 750 students

Site Specifics

- Chapel.
- Generous amounts of natural light throughout the school including operable windows for fresh air.
- Each wing has flexible teaching/resource areas for individual learning and team teaching.
- Central gathering area developed for multiple uses.
- Social areas provided for students from Grades 10 to 12.
- Breakout rooms, flexible multi-purpose areas (i.e. individualized study, testing, etc.)
- Library will incorporate both an open and reading with lots of natural light.
- Double tier 38 cm (15") lockers.
- Size: 7597 square metres.

Safety Features

- Clear visibility of front entry.
- Administration area adjacent to main entrance in clear view of school entrance.
- Control of entry through the administration area if school is locked down.
- Designed for community access to gymnasium and other select areas for after hours use.
- Separation of pedestrian and vehicle traffic.

Programming

- High school programming at Mother Margaret Mary Catholic High School will follow the program of studies for senior high schools as determined by Alberta Education.
- Students will have a choice of core academic courses that will give them access to all post-secondary institutions including the University of Alberta, N.A.I.T., Grant MacEwan College and more.
- A variety of optional courses will be offered including Visual Arts, Instrumental Music and Drama.
- Career and Technology Studies courses will offer students a broad range of choices that allow students to explore career and personal interest choices in greater depth: Fabrication Studies, Computer Sciences, Information Processing, Communication Technology, Foods, and Electro Technologies.

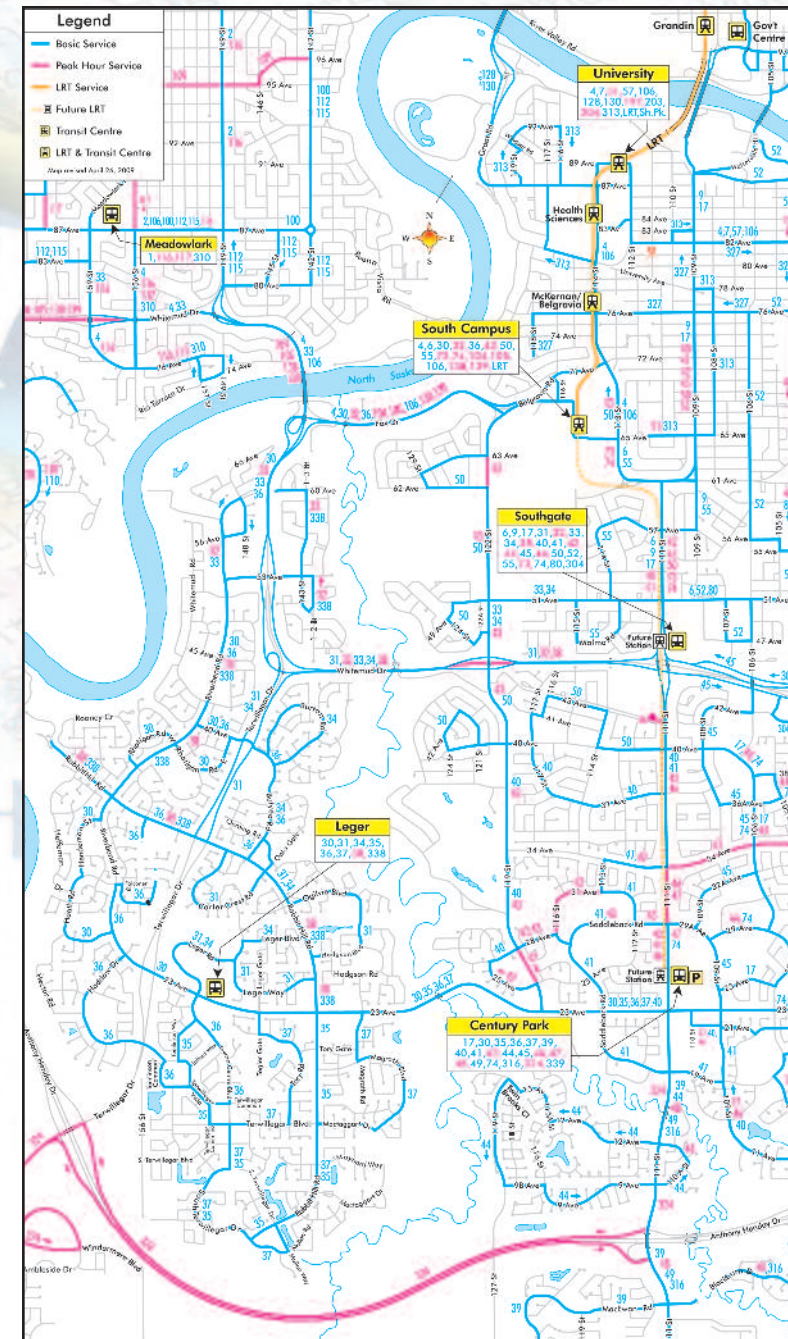

There are 14 revised routes that service the Riverbend/Terwillegar areas. These routes will be effective in April 2009. The majority of area residents will have improvements to their transit service as route changes have been designed to provide passengers with faster service and more reliable schedules. Local routes have been restructured to use the new Leger Transit Centre at the northeast corner of Leger Road and 23 Avenue.

Mother Margaret Mary Catholic High School

The attendance area for Mother Margaret Mary High School is bounded by the North Saskatchewan River to the west, the City boundaries to the south, and Whitemud creek to the east

